

БГ-7500Э

NO.	DESCRIPTION	SPEC.	NO.	DESCRIPTION	SPEC.
1	Engine subassembly		26	Isolator 2	
2	Rotor Assy		27	Fuel Tank	
3	Stator Assy		28	FLG. BOLT M6x20	M6x20mm
4	Stator Cover		29	WASHER TANK Buffer	
5	Generator end cover		30	OJOMMET, FUEL TANK	
6	Flange Bolt M10	M10	31	SCREW M5x10	M5x10mm
7	Lock WASHER ϕ 10	Φ 10mm	32	FUEL GAUGE ASSY.	
8	FLAT WASHER ϕ 10	Φ 10mm	33	FUEL CAP	
9	Flange Bolt M6	M6	34	FUEL FILTER, WIRE MESH	
10	Lock WASHER ϕ 6	Φ 6mm	35	FUEL VALVE	
11	FLAT WASHER ϕ 6	Φ 6mm	36	CONTROL BOX	
12	AVR		37	CONTROL PANEL	
13	FLG.BOLTM5x16	M5x16mm	38	FLG BOLT M6x 12	M6x12mm
14	Carbon brush assembly		40	ENGINE SWITCH	
15	Carbon brush holder		41	Cover 1	
16	BOLT & WASHER ASSEMBLIES		42	AC Circuit Breaker 24.8A	
17	BOLT & WASHER ASSEMBLIES		43	Ground Bolt Assy	
18	Terminal Block		44	Receptacle 16A	
19	Generator end cover cap		45	Receptacle 32A	
20	FLG.BOLT M5x12	M5x12mm	46	CONTROL PANEL ASSY	
21	Muffler assembly		47	Motor Assy	
22	FLG. BOLT M8x20	M8x20mm	48	Battery	
23	FRAME		49	Iron Fixing Belt	
24	NUT M8	M8	50	M6 Bolt	M6
25	Isolator 1				

БГ-7500Э-EX-20200902

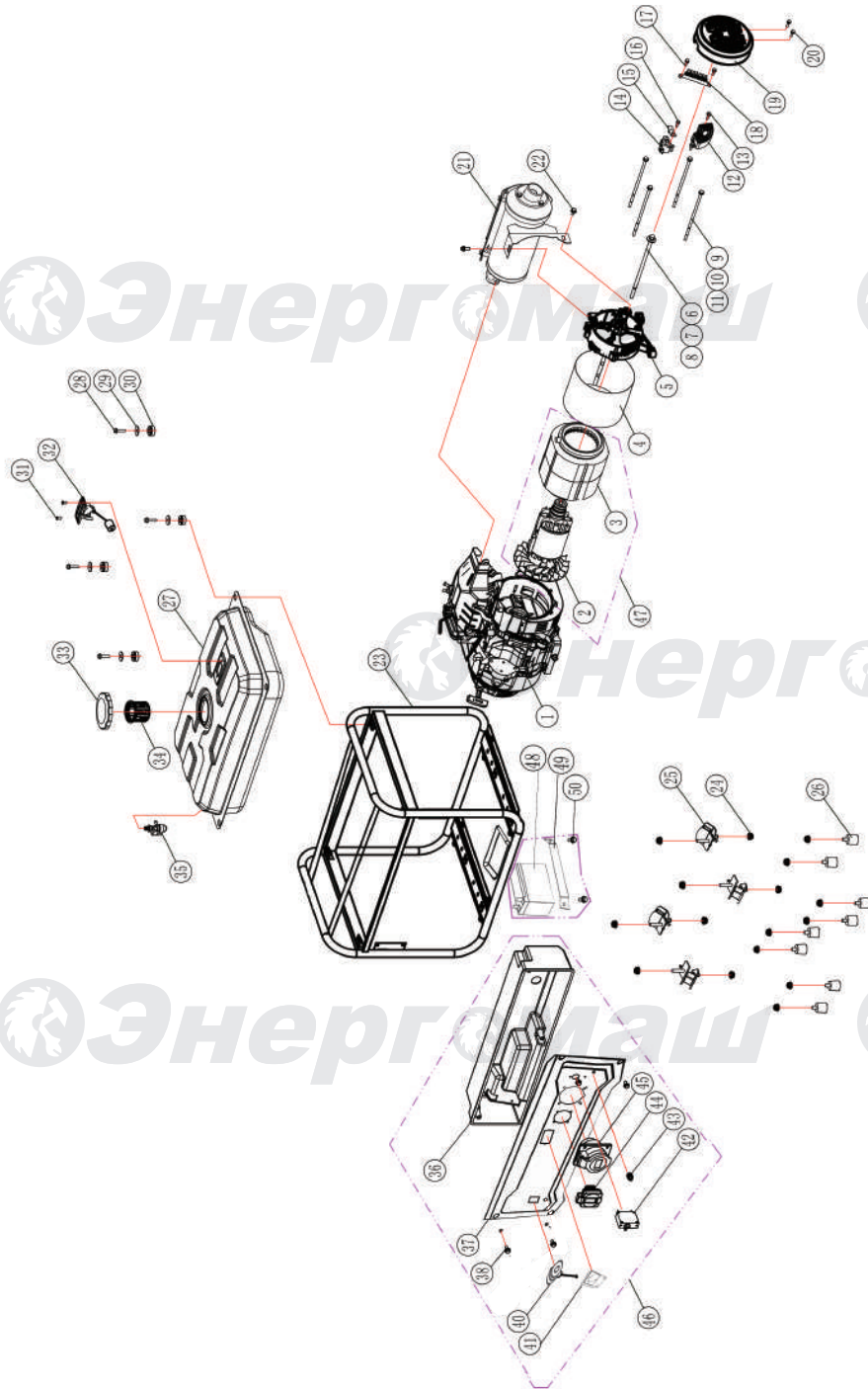

ENGINE FOR БГ-7500Э

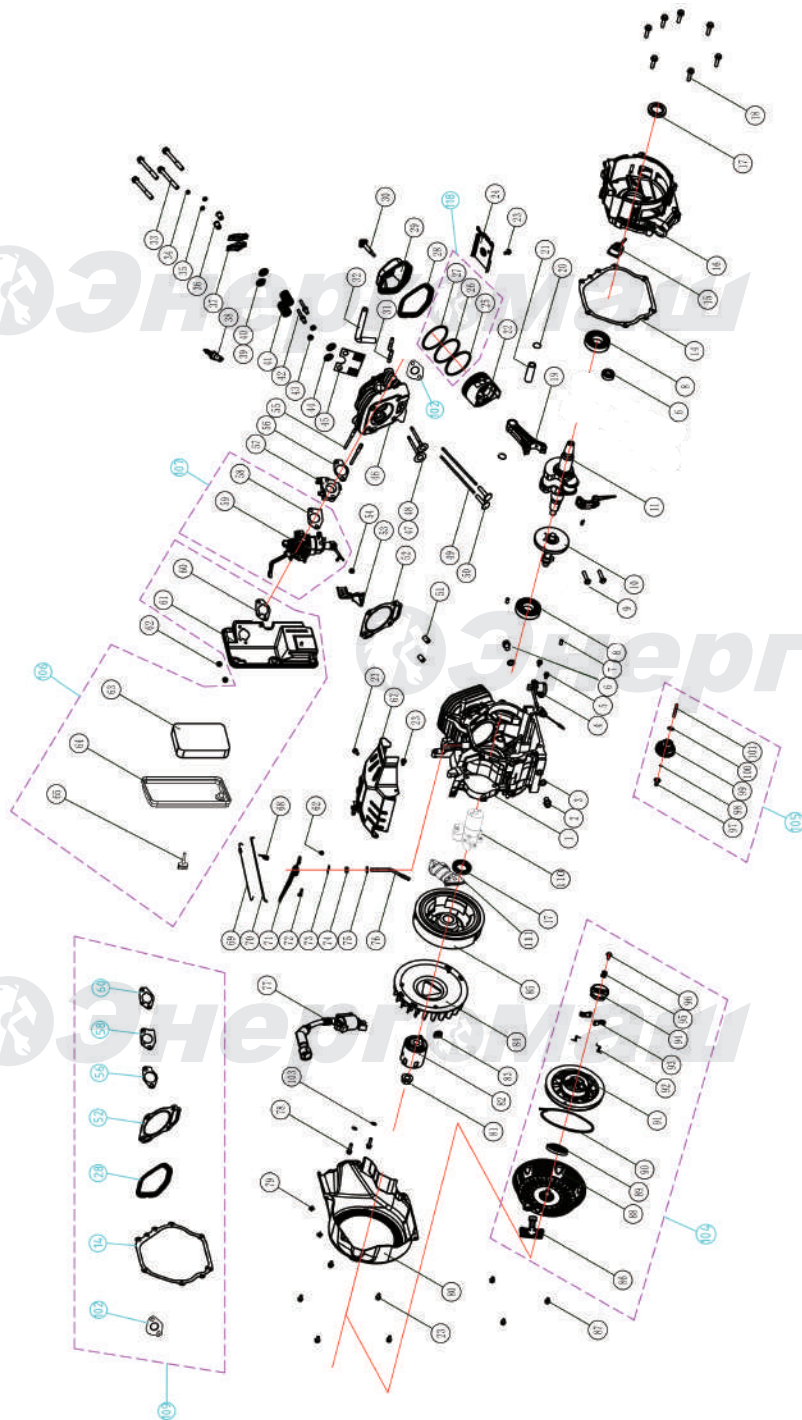

NO.	DESCRIPTION	SPEC.	NO.	DESCRIPTION	SPEC.
1	CRANKCASE SUBASSEMBLY.		58	GASKET, CARBURETOR	
2	BOLT, DRAIN PLUG		59	CARBURETOR	
3	WASHERDRAIN BOLT		60	GASKET, AIR CLEANER	
4	SENSOR, ENGINE OIL		61	ELBOW, AIR CLEANER	
5	FLG.BOLTM6X15	M6x15mm	62	NUT M6	M6
6	BOLT,DRAIN PLUG		63	ELEMENT, AIR CLEANER	
7	Locating Pins		64	COVER, AIR CLEANER	
8	Bearing		65	Bolt, COVER, AIR CLEANER	
9	Connect Rod Screw		67	WIND GUIDE, TOP	
10	CAMSHAFT ASSY.		68	SPRING,GOVERNOR	
11	CRANKSHAFT		69	SPRING, THROTTLE VALVE RETURNING	
14	GASKET, CRANKCASE		70	ROD, GOVERNOR	
15	OIL DIPSTICK ASSY		71	ARM, GOVERNOR	
16	COVERCRANKCASE		72	BOLT,GOVERNOR ARM	
17	SEAL, OIL		73	PIN, SHAFT	
18	FLG.BOLTM8X40	M8x40mm	74	SEAL, OIL	
19	ROD, CONNECTING(I)		75	Rocker shim	
20	CLIP, PISTON PIN		76	SHAFT, GOVERNOR ARM	
21	PIN, PISTON		77	IGNITION COIL	
22	PISTON		78	FLG.BOLT M6X29	M6x29mm
23	FLG.BOLT M6X12	M6x12mm	79	Wire clip	
24	AIR GUIDE LOWER		80	FAN COVER COMP	
25	RING SET, OIL		81	NUT, shaft	
26	RING, THE SECOND		82	PULLEY,STARTER	
27	RING, THE FIRST		83	SHEATH,WIRE	
28	GASKET, CYLINDER HEAD COVER		84	COOLING FAN	
29	COVER SUBASSEMBLY, CYLINDER HEAD		85	FLYWHEEL COMP	
30	BOLT		86	GRIP,STARTER	
31	Exhaust valves stud bolt		87	FLG.BOLT M6X8	M6x8mm
32	BREATHER TUBE		88	CASE COMP,RECOIL STARTER	
33	FLG. BOLT M10X80	M10x80mm	89	SPRING,STARTER RETURN	
34	ROTATOR, VALVE		90	CORD	
35	NUT, VALVE LOCK		91	PULLEY,RECOIL STARTER	
36	NUT VALVE ADJUSTING		92	SPRING,PATCHET	
37	ROCKER, VALVE		93	PATCHET,STARTER	
38	SPARKPLUG		94	PAWL GUIDE	
39	RETAINER, INTAKE VALVE		95	CLIP SPRG.,PAWL GUIDE	
40	RETAINER, EXHAUST VALVE		96	SCREW,PAWL GUIDE	
41	SPRING,VALVE		97	BUSHING, GOVORNER GEAR	
42	BOLT, VALVE ADJUSTING		98	CLIP, GOVORNER GEAR	
43	OIL SEAL,VALVE		99	GEAR, GOVERNOR	
44	RETAINER, VALVE		100	INNER WASHER,GEAR	
45	PLATE SUBASSEMBLY, LIFTER STOPPER		101	GOV.,CEAR SHAFT	
46	HEAD SUBASSEMBLY, CYLINDER		102	GSKT.,EXT.	
47	VALVE,IN.TAKE		103	Lock WASHER	
48	VALVE, EXHAUST		104	Recoil Starter Set	
49	PUSH ROD		105	Governing Gear Set	
50	TAPPET, VALVE		106	Air Cleaner Set	
51	Locating Pins(φ12x20)	φ12x20mm	107	Carburetor Set	
52	GASKET, CYLINDER HEAD		108	Piston Rings Set	
53	AIR cleaner holder		109	Gasket Set	
54	NUT M6	M6	110	Motor&Relay	
55	STUD, INTAKE		111	Battery Charing coil	
56	GSKT.,INSULATOR				
57	PLATE, CARBURETOR INSULATOR				